

REPORT OF GROUP DIRECTOR, NEIGHBOURHOODS AND HOUSING

LICENSING SUB-COMMITTEE: 03/03/2022	Classification DECISION	Enclosure
Application for a Premises Licence The Kings Land, 267 Kingsland Road, London, E2 8AS	Ward(s) affected Hoxton East and Shoreditch	

1. SUMMARY

Applicant(s): TKL INC Ltd	In SPA: N/A						
Date of Application 22/12/2021	Period of Application Permanent						
Proposed licensable activity Live Music Recorded Music Supply of Alcohol (On and Off Premises)							
Proposed hours of licensable activities <table> <tr> <td data-bbox="193 1227 798 1523"> Live Music </td> <td data-bbox="798 1227 1417 1523"> Standard Hours: Mon 12:00-00:00 Tue 12:00-00:00 Wed 12:00-00:00 Thu 12:00-00:00 Fri 12:00-00:00 Sat 12:00-00:00 Sun 12:00-00:00 </td> </tr> <tr> <td data-bbox="193 1559 798 1854"> Recorded Music </td> <td data-bbox="798 1559 1417 1854"> Standard Hours: Mon 12:00-02:30 Tue 12:00-02:30 Wed 12:00-02:30 Thu 12:00-04:30 Fri 12:00-04:30 Sat 12:00-04:30 Sun 12:00-02:30 </td> </tr> </table> <table> <tr> <td data-bbox="193 1890 798 2177"></td> <td data-bbox="798 1890 1417 2177"> Non-standard Hours: Christmas Eve (occurring on any day from Sunday to Wednesday from 12:00 to 04:30 on the day following). New Year's Eve (occurring on any day from Sunday to Wednesday from 12:00 to 04:30 the day following). On New Year's Eve occurring on any day </td> </tr> </table>		Live Music	Standard Hours: Mon 12:00-00:00 Tue 12:00-00:00 Wed 12:00-00:00 Thu 12:00-00:00 Fri 12:00-00:00 Sat 12:00-00:00 Sun 12:00-00:00	Recorded Music	Standard Hours: Mon 12:00-02:30 Tue 12:00-02:30 Wed 12:00-02:30 Thu 12:00-04:30 Fri 12:00-04:30 Sat 12:00-04:30 Sun 12:00-02:30		Non-standard Hours: Christmas Eve (occurring on any day from Sunday to Wednesday from 12:00 to 04:30 on the day following). New Year's Eve (occurring on any day from Sunday to Wednesday from 12:00 to 04:30 the day following). On New Year's Eve occurring on any day
Live Music	Standard Hours: Mon 12:00-00:00 Tue 12:00-00:00 Wed 12:00-00:00 Thu 12:00-00:00 Fri 12:00-00:00 Sat 12:00-00:00 Sun 12:00-00:00						
Recorded Music	Standard Hours: Mon 12:00-02:30 Tue 12:00-02:30 Wed 12:00-02:30 Thu 12:00-04:30 Fri 12:00-04:30 Sat 12:00-04:30 Sun 12:00-02:30						
	Non-standard Hours: Christmas Eve (occurring on any day from Sunday to Wednesday from 12:00 to 04:30 on the day following). New Year's Eve (occurring on any day from Sunday to Wednesday from 12:00 to 04:30 the day following). On New Year's Eve occurring on any day						

from Thursday to Saturday from the end of permitted hours on New Year's Eve to the start of permitted hours on the following day.

**Supply of Alcohol
(On and Off Sales)**

Standard Hours:

Mon 12:00-03:00
Tue 12:00-03:00
Wed 12:00-03:00
Thu 12:00-05:00
Fri 12:00-05:00
Sat 12:00-05:00
Sun 12:00-03:00

Non-standard Hours:

Christmas Eve (occurring on any day from Sunday to Wednesday from 12:00 to 05:00 on the day following).
New Year's Eve (occurring on any day from Sunday to Wednesday from 12:00 to 05:00 the day following).
On New Year's Eve occurring on any day from Thursday to Saturday from the end of permitted hours on New Year's Eve to the start of permitted hours on the following day.

The opening hours of the premises

Standard Hours:

Mon 12:00-03:00
Tue 12:00-03:00
Wed 12:00-03:00
Thu 12:00-05:00
Fri 12:00-05:00
Sat 12:00-05:00
Sun 12:00-03:00

Non-standard Hours:

Christmas Eve (occurring on any day from Sunday to Wednesday from 12:00 to 05:00 on the day following).
New Year's Eve (occurring on any day from Sunday to Wednesday from 12:00 to 05:00 the day following).
On New Year's Eve occurring on any day from Thursday to Saturday from the end of permitted hours on New Year's Eve to the start of permitted hours on the following day.

Capacity: Not known

Policies Applicable

LP1 (General Principles), LP2 (Licensing Objectives), LP3 (Core Hours), LP4 ('Off' Sales of Alcohol) and LP11(Cumulative Impact – General)

List of Appendices	A – Application for a premises licence and supporting documents B – Representations from Responsible Authority C - Representations from Other Persons D – Location map
Relevant Representations	<ul style="list-style-type: none"> • Police • Licensing Authority • Environmental Enforcement • Other Persons

2. APPLICATION

2.1 TKL INC Ltd has made an application for a premises licence under the Licensing Act 2003:

- To authorise the supply alcohol for consumption on and off the premises
- To provide regulated entertainment

2.2 The application is attached as Appendix A. The applicant has proposed measures that could be converted to conditions (see paragraph 8.1 below).

3. CURRENT STATUS / HISTORY

3.1 The premises has previously held a premises licence and the licence was surrendered in August 2020.

3.2 Temporary Event Notices have been given for events in the last twelve months at this premises as follows:

Date of the event(s)	Hours
16/12/21-19/12/21	16:00-00:30
23/12/21-27/12/21	12:00-01:00
29/12/21-03/01/22	12:00-01:00
28/01/22-30/01/22	16:00-00:30
25/02/22-27/02/22	16:00-01:00

4. REPRESENTATIONS: RESPONSIBLE AUTHORITIES

From	Details
Environmental Health Authority (Environmental Protection)	Representation withdrawn based on agreed conditions as set out in para 8.1
Environmental Health Authority (Environmental Enforcement) (Appendix B3)	Representation received on the grounds of The Prevention of Public Nuisance
Environmental Health Authority (Health & Safety)	No representation received
Weights and Measures (Trading Standards)	No representation received
Planning Authority	No representation received
Area Child Protection Officer	No representation received

Fire Authority	No representation received
Police (Appendix B1)	Representation received on the grounds of The Prevention of Crime and Disorder and Prevention of Public Nuisance
Licensing Authority (Appendix B2)	Representation received on the grounds of public safety and Prevention of Public Nuisance
Health Authority	No representation received

5. REPRESENTATIONS: OTHER PERSONS

From	Details
13 Representations opposing the application received from and on behalf of local residents. (Appendices C1-C13).	Representation received on the grounds of The Prevention of Crime and Disorder, Public Safety, Prevention of Public Nuisance and The Protection of Children from Harm.

6. GUIDANCE CONSIDERATIONS

- 6.1 The Licensing Authority is required to have regard to any guidance issued by the Secretary of State under the Licensing Act 2003.

7. POLICY CONSIDERATIONS

- 7.1 Licensing Sub-Committee is required to have regard to the London Borough of Hackney's Statement of Licensing Policy ("the Policy") adopted by the Licensing Authority.
- 7.2 The Policy applies to applications where relevant representations have been made. With regard to this application, policies, LP1 (General Principles), LP2 (Licensing Objectives), LP3 (Core Hours), LP4 ('Off' Sales of Alcohol) and LP11 (Cumulative Impact – General) are relevant.

8. OFFICER OBSERVATIONS

- 8.1 If the Sub-Committee is minded to approve the application, the following conditions should be applied the licence:

Supply Of Alcohol (On/Both)

- 1.No supply of alcohol may be made under the premises licence:
 - (a) At a time when there is no designated premises supervisor in respect of the premises licence.
 - (b) At a time when the designated premises supervisor does not hold a personal licence or his personal licence is suspended.
2. Every supply of alcohol under the premises licence must be made or authorised by a person who holds a personal licence.
3. (1) The responsible person must ensure that staff on relevant premises do not carry out, arrange or participate in any irresponsible promotions in relation to the premises.
 - (2) In this paragraph, an irresponsible promotion means any one or more of

the following activities, or substantially similar activities, carried on for the purpose of encouraging the sale or supply of alcohol for consumption on the premises -

(a) games or other activities which require or encourage, or are designed to require or encourage, individuals to;

(i) drink a quantity of alcohol within a time limit (other than to drink alcohol sold or supplied on the premises before the cessation of the period in which the responsible person is authorised to sell or supply alcohol), or

(ii) drink as much alcohol as possible (whether within a time limit or otherwise);

(b) provision of unlimited or unspecified quantities of alcohol free or for a fixed or discounted fee to the public or to a group defined by a particular characteristic in a manner which carries a significant risk of undermining a licensing objective;

(c) provision of free or discounted alcohol or any other thing as a prize to encourage or reward the purchase and consumption of alcohol over a period of 24 hours or less in a manner which carries a significant risk of undermining a licensing objective;

(d) selling or supplying alcohol in association with promotional posters or flyers on, or in the vicinity of, the premises which can reasonably be considered to condone, encourage or glamorise anti-social behaviour or to refer to the effects of drunkenness in any favourable manner.

(e) dispensing alcohol directly by one person into the mouth of another (other than where that other person is unable to drink without assistance by reason of a disability).

4. The responsible person must ensure that free potable water is provided on request to customers where it is reasonably available.

5. 5.1. The premises licence holder or club premises certificate holder must ensure that an age verification policy is adopted in respect of the premises in relation to the sales or supply of alcohol.

5.2 The designated premises supervisor in relation to the premises licences must ensure that the supply of alcohol at the premises is carried on in accordance with the age verification policy.

5.3. The policy must require individuals who appear to the responsible person to be under 18 years if age (or such older age as may be specified in the policy) to produce on request, before being served alcohol, identification bearing their photograph, date of birth and either:-

- A. a holographic mark or
- B. an ultraviolet feature.

6. The responsible person shall ensure that:

a) where any of the following alcoholic drinks is sold or supplied for consumption on the premises (other than alcoholic drinks sold or supplied having been made up in advance ready for sale or supply in a securely closed container) it is available to customers in the following measures:

- beer or cider: 1/2 pint;
- gin, rum, vodka or whisky: 25ml or 35ml; and
- still wine in a glass: 125ml; and

a. these measures are displayed in a menu, price list or other printed

material which is available to customers on the premises; and

b. where a customer does not in relation to a sale of alcohol specify the quantity of alcohol to be sold, the customer is made aware that these measures are available.

Minimum Drinks Pricing

7. 7.1 A relevant person shall ensure that no alcohol is sold or supplied for consumption on or off the premises for a price which is less than the permitted price.

7.2 For the purposes of the condition set out in paragraph 7.1 above -

(a) "duty" is to be construed in accordance with the Alcoholic Liquor Duties Act 1979;

(i) "permitted price" is the price found by applying the formula - $P = D + (D \times V)$
Where -P is the permitted price,

(ii) D is the amount of duty chargeable in relation to the alcohol as if the duty were charged on the date of the sale or supply of the alcohol, and

(iii) V is the rate of value added tax chargeable in relation to the alcohol as if the value added tax were charged on the date of the sale or supply of the alcohol;

(b) "relevant person" means, in relation to premises in respect of which there is in force a premises licence -

(i) the holder of the premises licence,

(ii) the designated premises supervisor (if any) in respect of such a licence, or

(iii) the personal licence holder who makes or authorises a supply of alcohol under such a licence;

(c) "relevant person" means, in relation to premises in respect of which there is in force a club premises certificate, any member or officer of the club present on the premises in a capacity which enables the member or officer to prevent the supply in question; and

(d) "value added tax" means value added tax charged in accordance with the Value Added Tax Act 1994.

7.3 Where the permitted price given by Paragraph 8.2(b) above would (apart from this paragraph) not be a whole number of pennies, the price given by that sub-paragraph shall be taken to be the price actually given by that sub-paragraph rounded up to the nearest penny.

7.4 (1) Sub-paragraph 7.4(2) below applies where the permitted price given by Paragraph 7.2(b) above on a day ("the first day") would be different from the permitted price on the next day ("the second day") as a result of a change to the rate of duty or value added tax.

(2) The permitted price which would apply on the first day applies to sales or supplies of alcohol which take place before the expiry of the period of 14 days beginning on the second day.

Door Supervision

8. Each individual who is to carry out a security activity at the premises must be licensed by the Security Industry Authority.

Conditions consistent with the operating schedule

9. The licensee shall install a comprehensive CCTV system that ensures all areas of the licensed premises are monitored including all entry points, and which enable frontal identification of every person entering in any light condition. All cameras shall continually record whilst the premises are in operation and the recording shall be kept available for a minimum of 31 days with time and date stamping. Recordings shall be made available to a duly authorised Hackney council officer or a police officer upon request. The CCTV system shall be operated in accordance with the data protection act 1998 and any other relevant legislation.
10. No less than one member of staff who is able to operate the CCTV system shall be on the premises whenever the premises is operational.
11. A minimum of one SIA registered door staff per 100 patrons to be employed at the venue after 2200hrs. Additional male and female SIA door staff to be employed at the premises when required on the basis of an operational risk assessment with identity badges displayed at all times and SIA numbers, full names, times worked and duty performed to be entered into an occurrence book and made available to police immediately upon request.
12. An incident log shall be kept at the premises and made available on request to an authorised officer of the council or the Police, which will record the following as a minimum;
 - a. All crimes reported to the venue
 - b. All ejections of patrons
 - c. Any complaints received
 - d. Any incidents of disorder
 - e. Seizures of drugs or weapons
 - f. Any CCTV faults, search equipment faults or scanning equipment faults
 - g. Any refusal of the sale of alcohol
 - h. Any visit by a relevant authority or emergency service.
13. The licensee shall operate a zero tolerance policy to drugs and comply with the Hackney Police/Community Safety Unit Drugs and Weapons policy. Prominent signage highlighting zero tolerance to drugs and weapons shall be displayed at the entrance and within the premises.
14. The premises will maintain a written search policy to be operated within the premises, the aim of which is to deter customers from bringing illegal items, drugs and/or weapons into the premises.
15. A written record shall be kept detailing all refused sales of alcohol. The record should be kept on the premises, and made available for inspection on request by any duly authorised officer. Records should be kept for a minimum 12 months.
16. The licensee shall display the telephone and email address of the Designated Premises Supervisor for use by any person who may wish to make a complaint during the opening hours of the premises. The number/email address should be displayed in a prominent external location which is easily accessible to the public.
17. Staff must carry out regular, random toilet checks, at least once per hour when the premises is open to the public for evidence of any crime. These checks are

to be documented and kept for a minimum 31 days and made available on request for inspection by the Police.

18. Customers will not be allowed to leave the premises with glass or any other open container.
19. There shall be no entry or re-entry to the premises after 0100hrs by members of the public save for those that have temporarily left the premises to smoke.
20. There shall be a written dispersal policy, a copy of which shall be kept on the premises and made available to police or authorised officer upon request.
21. Clear and prominent notices shall be displayed and maintained at all exits in a place where they can be seen and easily read by customers requesting them to leave the premises and the area quietly.
22. No more than 10 smokers will be permitted in the designated smoking area after 9pm.
23. The premises shall operate a challenge 25 scheme. Any person who appears to be under the age of 25 shall be asked to provide proof of age identification in the form of a passport, photo driving licence or PASS proof of age card. Failure to provide such identification will result in a refusal to sell alcohol and detailed in the refusals book.
24. Prominent, clear notices shall be displayed at the point of entry and in prominent areas around the premises outlining the Challenge 25 policy.
25. All staff will receive training in regards the relevant legislation relating to the sale of alcohol, particularly under age sales and sales to drunks. Records of such training will be maintained on the premises and refresher training will be carried out on a 6 to 12 month basis.
26. Reasonable steps to be taken to ensure an authorised person is a member of Pub watch and SNOW, the membership is kept up to date and at least 3 meetings a year are attended.
27. All children to be accompanied by a responsible adult. Children to leave the premises by 1900hrs.
28. Premises to operate a no baseball caps or hooded tops policy and no alcohol promotions eg; Happy hour or 2 for 1.
29. Noise limiter to be employed in a separate and remote (from the volume control) lockable cabinet must be fitted to the music amplification system. No supplementary sound system to be used by acts without a full risk assessment and prior notice given to Hackney noise pollution department and Hackney Police.
30. Adequate/improved security lighting outside the premises with consideration being given to light pollution of neighbouring properties. All entrances to the venue to be lit and painted white to enable better quality of CCTV images for identification purposes.
31. The premises will also, in cooperation with Hackney Police and no later than 3 months following the granting of the premises licence, regularly facilitate a

premises drug audit using the Ion Itemiser or similar device.

32. Queues to be supervised by door staff to prevent disorder and measures to be implemented aimed at discouraging anti-social behaviour.
33. Premises will provide the police with a dispersal policy and comply with its contents to ensure that all patrons leave the venue and the vicinity quickly and quietly. Notices to be displayed at all exits requesting that patrons respect the needs of local residents and leave the premises and the area quietly.
34. All staff employed at the premises should be over 18 years old and photo identification has been seen to confirm this.
35. A member of staff shall run the cloakroom whenever licensable activities are taking place.

Conditions derived from Responsible Authority representations

36. All windows and external doors shall be kept closed at any time when regulated entertainment takes place, except for the immediate access and egress of persons
37. No noise shall emanate from the premises nor vibration be transmitted through the structure of the premises that gives rise to a nuisance.
38. A tamper-proof noise-limiting device shall be fitted to the sound system within the premises and all amplified music played at the premises must pass through this sound limiter at a level that will not cause nuisance. The noise limiter shall not be altered without prior agreement with the Council's Environmental Protection Team.
39. While live or recorded music takes place, the licensee or management shall undertake regular monitoring of noise levels at the nearest noise-sensitive locations. A record shall be kept of any monitoring, including the date, time and location of monitoring; the name of the monitor; and any action taken. Records shall be kept for no less than six months and shall be made available upon request by a police officer or an authorised officer of Hackney Council.
40. Notices shall be prominently displayed at any area used for smoking, requesting patrons to respect the needs of local residents and use the area quietly.
41. Staff shall monitor customers smoking outside the premises on a regular basis and ensure patrons do not cause a public nuisance.
42. The number of smokers allowed to use the smoking designated area from 22:00 is restricted to 6 people.
43. There shall be a documented dispersal policy, as agreed with the Environmental Protection Team, implemented at the premises and a copy lodged with the Council's Licensing Unit.
44. Notices shall be prominently displayed at all exits requesting patrons to respect the needs of local residents and leave the area quietly.
45. The Licensee shall ensure that all relevant staff are fully trained and made aware of the legal requirement of businesses to comply with their responsibility as

regards the disposal of waste produced from the business premises. The procedure for handling and preparing for disposal of the waste shall be in writing and displayed in a prominent place where it can be referred to at all times by staff.

46. The Licensee shall ensure that any contract for general and recyclable waste disposal shall be appropriate in size to the amount of waste produced by the business. The Licensee shall maintain an adequate supply of waste receptacles provided by his registered waste carrier (refuse sacks or commercial waste bins) in order to ensure all refuse emanating from the business is always presented for collection by his waste carrier and shall not use any plain black or unidentifiable refuse sacks or any other unidentifiable or unmarked waste receptacles.
47. The Licensee's premises are situated in an area within which refuse may only be left on the public highway at certain times (time bands). If the Licensee's waste carrier cannot or does not comply by collecting the refuse within an hour after the close of any time band imposed by the waste authority, the Licensee must remove the refuse from the public highway and/or keep it within the premises until such time as his/her waste carrier arrives to collect the refuse.
48. The Licensee shall instruct members of staff to make regular checks of the area immediately outside the premises and remove any litter, bottles and glasses emanating from the premises. A final check should be made at close of business.
49. The Licensee shall provide a safe receptacle for cigarette ends to be placed outside for the use of customers, such receptacle being carefully placed so as not to cause an obstruction or trip.
50. The current trade waste agreement/duty of care waste transfer document shall be conspicuously displayed and maintained in the window of the premises where it can be conveniently seen and read by persons standing in The Kings Land. This should remain unobstructed at all times and should clearly identify:-
 - the name of the registered waste carrier
 - the date of commencement of trade waste contract
 - the date of expiry of trade waste contract
 - the days and times of collection
 - the type of waste including the European Waste Code

9. REASONS FOR OFFICER OBSERVATIONS

- 9.1 Conditions 9 to 35 are derived from applicant's operating schedule, conditions 36 to 44 have been agreed with Environmental Protection and conditions 45 to 50 have been proposed by the Environmental Enforcement.

10. LEGAL COMMENTS

- 10.1 The Council has a duty as a Licensing Authority under the Licensing Act 2003 to carry out its functions with a view to promoting the following 4 licensing objectives;
 - The Prevention of Crime and Disorder
 - Public Safety
 - Prevention of Public Nuisance
 - The Protection of Children from Harm

10.2 It should be noted that each of the licensing objectives have equal importance and are the only grounds upon which a relevant representation can be made and for which an application can be refused or terms and conditions attached to a licence.

11. HUMAN RIGHTS ACT 1998 IMPLICATIONS

- 11.1 There are implications to;
- **Article 6** – Right to a fair hearing
 - **Article 14** – Not to discriminate
 - Balancing: **Article 1**- Peaceful enjoyment of their possession (i.e. a licence is defined as being a possession) with **Article 8** – Right of Privacy (i.e. respect private & family life) to achieve a proportionate decision having regard to the protection of an individuals rights against the interests of the community at large.

12. MEMBERS DECISION MAKING

- A. **Option 1**
That the application be refused
- B. **Option 2**
That the application be approved, together with any conditions or restrictions which Members consider necessary for the promotion of the Licensing objectives.

13. CONCLUSION

13.1 That Members decide on the application under the Licensing Act 2003.

Group Director, Neighbourhoods and Housing	Ajman Ali
Lead Officer (holder of original copy):	Shan Uthaysanagar Licensing Officer Licensing Service 1 Hillman Street E8 1DY Telephone: 020 8356 2431

LIST OF BACKGROUND PAPERS RELATING TO THIS REPORT

The following document(s) has been relied upon in the preparation of the report.

Description of document	Location
The Kings Land, 267 Kingsland Road, London, E2 8AS	Licensing Service 1 Hillman Street London E8 1DY

Printed matter
Licensing Act 2003
LBH Statement of Licensing Policy

Hackney
LA01

Application for a premises licence to be granted under the Licensing Act 2003

PLEASE READ THE FOLLOWING INSTRUCTIONS FIRST

Before completing this form please read the guidance notes at the end of the form. If you are completing this form by hand please write legibly in block capitals. In all cases ensure that your answers are inside the boxes and written in black ink. Use additional sheets if necessary.

You may wish to keep a copy of the completed form for your records.

I/We TKL INC Ltd

(Insert name(s) of applicant)

apply for a premises licence under section 17 of the Licensing Act 2003 for the premises described in Part 1 below (the premises) and I/we are making this application to you as the relevant licensing authority in accordance with section 12 of the Licensing Act 2003

Part 1 – Premises details

Postal address of premises or, if none, ordnance survey map reference or description The Kings Land 267 Kingsland Road			
Post town	London	Postcode	E2 8AS

Telephone number at premises (if any)	
Non-domestic rateable value of premises	£56500

Part 2 - Applicant details

Please state whether you are applying for a premises licence as **Please tick as appropriate**

- a) an individual or individuals * please complete section (A)
- b) a person other than an individual *
 - i as a limited company/limited liability partnership please complete section (B)
 - ii as a partnership (other than limited liability) please complete section (B)
 - iii as an unincorporated association or please complete section (B)

- iv other (for example a statutory corporation) please complete section (B)
- c) a recognised club please complete section (B)
- d) a charity please complete section (B)
- e) the proprietor of an educational establishment please complete section (B)
- f) a health service body please complete section (B)
- g) a person who is registered under Part 2 of the Care Standards Act 2000 (c14) in respect of an independent hospital in Wales please complete section (B)
- ga) a person who is registered under Chapter 2 of Part 1 of the Health and Social Care Act 2008 (within the meaning of that Part) in an independent hospital in England please complete section (B)
- h) the chief officer of police of a police force in England and Wales please complete section (B)

* If you are applying as a person described in (a) or (b) please confirm (by ticking yes to one box below):

- I am carrying on or proposing to carry on a business which involves the use of the premises for licensable activities; or
- I am making the application pursuant to a
 - statutory function or
 - a function discharged by virtue of Her Majesty's prerogative

(A) INDIVIDUAL APPLICANTS (fill in as applicable)

Mr <input type="checkbox"/>	Mrs <input type="checkbox"/>	Miss <input type="checkbox"/>	Ms <input type="checkbox"/>	Other Title (for example, Rev)	
Surname			First names		
Date of birth		I am 18 years old or over <input type="checkbox"/> Please tick yes			
Nationality					
Current residential address if different from premises address					
Post town				Postcode	

Daytime contact telephone number	
E-mail address (optional)	
Where applicable (if demonstrating a right to work via the Home Office online right to work checking service), the 9-digit 'share code' provided to the applicant by that service (please see note 15 for information)	

SECOND INDIVIDUAL APPLICANT (if applicable)

Mr <input type="checkbox"/>	Mrs <input type="checkbox"/>	Miss <input type="checkbox"/>	Ms <input type="checkbox"/>	Other Title (for example, Rev)	
Surname			First names		
Date of birth		I am 18 years old or over <input type="checkbox"/> Please tick yes			
Nationality					
Current postal address if different from premises address					
Post town		Postcode			
Daytime contact telephone number					
E-mail address (optional)					
Where applicable (if demonstrating a right to work via the Home Office online right to work checking service), the 9-digit 'share code' provided to the applicant by that service (please see note 15 for information)					

(B) OTHER APPLICANTS

Please provide name and registered address of applicant in full. Where appropriate please give any registered number. In the case of a partnership or other joint venture (other than a body corporate), please give the name and address of each party concerned.

Name TKL INC Ltd

Address 267 Kingsland Road London E2 8AS
Registered number (where applicable) 13813922
Description of applicant (for example, partnership, company, unincorporated association etc.) Private Limited Company
Telephone number (if any) [REDACTED]
E-mail address (optional) [REDACTED]

Part 3 Operating Schedule

When do you want the premises licence to start?

DD	MM	YYYY
2	0	0 1 2 0 2 2

If you wish the licence to be valid only for a limited period, when do you want it to end?

DD	MM	YYYY

Please give a general description of the premises (please read guidance note 1) Public House

If 5,000 or more people are expected to attend the premises at any one time, please state the number expected to attend.

--

What licensable activities do you intend to carry on from the premises?

(Please see sections 1 and 14 and Schedules 1 and 2 to the Licensing Act 2003)

- | Provision of regulated entertainment (please read guidance note 2) | Please tick all that apply |
|---|-------------------------------------|
| a) plays (if ticking yes, fill in box A) | <input type="checkbox"/> |
| b) films (if ticking yes, fill in box B) | <input type="checkbox"/> |
| c) indoor sporting events (if ticking yes, fill in box C) | <input type="checkbox"/> |
| d) boxing or wrestling entertainment (if ticking yes, fill in box D) | <input type="checkbox"/> |
| e) live music (if ticking yes, fill in box E) | <input checked="" type="checkbox"/> |
| f) recorded music (if ticking yes, fill in box F) | <input checked="" type="checkbox"/> |
| g) performances of dance (if ticking yes, fill in box G) | <input type="checkbox"/> |
| h) anything of a similar description to that falling within (e), (f) or (g) (if ticking yes, fill in box H) | <input type="checkbox"/> |
| Provision of late night refreshment (if ticking yes, fill in box I) | <input type="checkbox"/> |
| Supply of alcohol (if ticking yes, fill in box J) | <input checked="" type="checkbox"/> |

In all cases complete boxes K, L and M

A

Plays Standard days and timings (please read guidance note 7)			Will the performance of a play take place indoors or outdoors or both – please tick (please read guidance note 3)	Indoors	<input type="checkbox"/>
				Outdoors	<input type="checkbox"/>
				Both	<input type="checkbox"/>
Day	Start	Finish	Please give further details here (please read guidance note 4)		
Mon					
Tue			State any seasonal variations for performing plays (please read guidance note 5)		
Wed					
Thur			Non-standard timings. Where you intend to use the premises for the performance of plays at different times to those listed in the column on the left, please list (please read guidance note 6)		
Fri					
Sat					
Sun					

B

Films Standard days and timings (please read guidance note 7)			Will the exhibition of films take place indoors or outdoors or both – please tick (please read guidance note 3)	Indoors	<input type="checkbox"/>
				Outdoors	<input type="checkbox"/>
				Both	<input type="checkbox"/>
Day	Start	Finish	Please give further details here (please read guidance note 4)		
Mon					
			State any seasonal variations for the exhibition of films (please read guidance note 5)		
Tue					
			Non-standard timings. Where you intend to use the premises for the exhibition of films at different times to those listed in the column on the left, please list (please read guidance note 6)		
Wed					
Thur					
Fri					
Sat					
Sun					

C

Indoor sporting events Standard days and timings (please read guidance note 7)			Please give further details (please read guidance note 4)
Day	Start	Finish	
Mon			State any seasonal variations for indoor sporting events (please read guidance note 5)
Tue			Non-standard timings. Where you intend to use the premises for indoor sporting events at different times to those listed in the column on the left, please list (please read guidance note 6)
Wed			
Thur			
Fri			
Sat			
Sun			

D

Boxing or wrestling entertainments Standard days and timings (please read guidance note 7)			Will the boxing or wrestling entertainment take place indoors or outdoors or both – please tick (please read guidance note 3)	Indoors	<input type="checkbox"/>
				Outdoors	<input type="checkbox"/>
Day	Start	Finish		Both	<input type="checkbox"/>
Mon			Please give further details here (please read guidance note 4)		
Tue					
Wed			State any seasonal variations for boxing or wrestling entertainment (please read guidance note 5)		
Thur					
Fri			Non-standard timings. Where you intend to use the premises for boxing or wrestling entertainment at different times to those listed in the column on the left, please list (please read guidance note 6)		
Sat					
Sun					

E

Live music Standard days and timings (please read guidance note 7)			Will the performance of live music take place indoors or outdoors or both – please tick (please read guidance note 3)	Indoors	<input checked="" type="checkbox"/>			
				Outdoors	<input type="checkbox"/>			
				Both	<input type="checkbox"/>			
Day	Start	Finish	Please give further details here (please read guidance note 4)					
Mon	1200	0000						
Tue	1200	0000						
Wed	1200	0000				State any seasonal variations for the performance of live music (please read guidance note 5)		
Thur	1200	0000						
Fri	1200	0000				Non-standard timings. Where you intend to use the premises for the performance of live music at different times to those listed in the column on the left, please list (please read guidance note 6)		
Sat	1200	0000						
Sun	1200	0000						

F

Recorded music Standard days and timings (please read guidance note 7)			Will the playing of recorded music take place indoors or outdoors or both – please tick (please read guidance note 3)	Indoors	<input checked="" type="checkbox"/>
				Outdoors	<input type="checkbox"/>
				Both	<input type="checkbox"/>
Day	Start	Finish	Please give further details here (please read guidance note 4)		
Mon	1200	0230			
Tue	1200	0230	State any seasonal variations for the playing of recorded music (please read guidance note 5)		
Wed	1200	0230			
Thur	1200	0430	Non-standard timings. Where you intend to use the premises for the playing of recorded music at different times to those listed in the column on the left, please list (please read guidance note 6)		
Fri	1200	0430			
Sat	1200	0430	Christmas Eve(occurring on any day from Sunday to Wednesday from 1200 to 0430 on the day following. New Years Eve (occurring any day from Sunday to Wednesday from 1200 to 0430 the day following).		
Sun	1200	0230			
			On New Years Eve occurring on any day from Thursday to Saturday from the end of permitted hours on New Years Eve to the start of permitted hours on the following day.		

G

Performances of dance Standard days and timings (please read guidance note 7)			Will the performance of dance take place indoors or outdoors or both – please tick (please read guidance note 3)	Indoors	<input type="checkbox"/>
				Outdoors	<input type="checkbox"/>
Day	Start	Finish		Both	<input type="checkbox"/>
Mon			Please give further details here (please read guidance note 4)		
Tue					
Wed			State any seasonal variations for the performance of dance (please read guidance note 5)		
Thur					
Fri			Non-standard timings. Where you intend to use the premises for the performance of dance at different times to those listed in the column on the left, please list (please read guidance note 6)		
Sat					
Sun					

H

<p>Anything of a similar description to that falling within (e), (f) or (g) Standard days and timings (please read guidance note 7)</p>			<p>Please give a description of the type of entertainment you will be providing</p>		
Day	Start	Finish	<p>Will this entertainment take place indoors or outdoors or both – please tick (please read guidance note 3)</p>	Indoors	<input type="checkbox"/>
Mon				Outdoors	<input type="checkbox"/>
				Both	<input type="checkbox"/>
Tue			<p>Please give further details here (please read guidance note 4)</p>		
Wed					
Thur			<p>State any seasonal variations for entertainment of a similar description to that falling within (e), (f) or (g) (please read guidance note 5)</p>		
Fri					
Sat			<p>Non-standard timings. Where you intend to use the premises for the entertainment of a similar description to that falling within (e), (f) or (g) at different times to those listed in the column on the left, please list (please read guidance note 6)</p>		
Sun					

I

Late night refreshment Standard days and timings (please read guidance note 7)			Will the provision of late night refreshment take place indoors or outdoors or both – please tick (please read guidance note 3)	Indoors	<input type="checkbox"/>
				Outdoors	<input type="checkbox"/>
Day	Start	Finish		Both	<input type="checkbox"/>
Mon			Please give further details here (please read guidance note 4)		
Tue					
Wed			State any seasonal variations for the provision of late night refreshment (please read guidance note 5)		
Thur					
Fri			Non-standard timings. Where you intend to use the premises for the provision of late night refreshment at different times, to those listed in the column on the left, please list (please read guidance note 6)		
Sat					
Sun					

J

Supply of alcohol Standard days and timings (please read guidance note 7)			Will the supply of alcohol be for consumption – please tick (please read guidance note 8)	On the premises	<input type="checkbox"/>
				Off the premises	<input type="checkbox"/>
				Both	<input checked="" type="checkbox"/>
Day	Start	Finish	State any seasonal variations for the supply of alcohol (please read guidance note 5)		
Mon	1200	0300			
Tue	1200	0300			
Wed	1200	0300			
Thur	1200	0500			
Fri	1200	0500			
Sat	1200	0500			
Sun	1200	0300	Non-standard timings. Where you intend to use the premises for the supply of alcohol at different times to those listed in the column on the left, please list (please read guidance note 6) Christmas Eve(occurring on any day from Sunday to Wednesday from 1200 to 0500 on the day following. New Years Eve (occurring any day from Sunday to Wednesday from 1200 to 0500 the day following). On New Years Eve occurring on any day from Thursday to Saturday from the end of permitted hours on New Years Eve to the start of permitted hours on the following day.		

State the name and details of the individual whom you wish to specify on the licence as designated premises supervisor (Please see declaration about the entitlement to work in the checklist at the end of the form):

Name Ismail Tezgel	
Date of birth	██████████
Address ██████████	
Postcode	██████████
Personal licence number (if known) ██████████	
Issuing licensing authority (if known) ██████████	

K

Please highlight any adult entertainment or services, activities, other entertainment or matters ancillary to the use of the premises that may give rise to concern in respect of children (please read guidance note 9).

No activity of this nature will occur

L

Hours premises are open to the public Standard days and timings (please read guidance note 7)			State any seasonal variations (please read guidance note 5)
Day	Start	Finish	
Mon	1200	0300	Non-standard timings. Where you intend the premises to be open to the public at different times from those listed in the column on the left, please list (please read guidance note 6) Christmas Eve(occurring on any day from Sunday to Wednesday from 1200 to 0500 on the day following. New Years Eve (occurring any day from Sunday to Wednesday from 1200 to 0500 the day following). On New Years Eve occurring on any day from Thursday to Saturday from the end of permitted hours on New Years Eve to the start of permitted hours on the following day.
Tue	1200	0300	
Wed	1200	0300	
Thur	1200	0500	
Fri	1200	0500	
Sat	1200	0500	
Sun	1200	0300	

M Describe the steps you intend to take to promote the four licensing objectives:

a) General – all four licensing objectives (b, c, d and e) (please read guidance note 10)

The premises licence holder is a responsible operator who is aware of the 4 Licensing objectives, the Council's licensing policy and their responsibilities under the Licensing Act 2003. The business is run lawfully and in accordance with good business practice and offers the following conditions to be attached to the premises licence.
All health & safety, fire and other legal commitments will be complied with under the relevant legislation.

1. The licensee shall install a comprehensive CCTV system that ensures all areas of the licensed premises are monitored including all entry points, and which enable frontal identification of every person entering in any light condition. All cameras shall continually record whilst the premises are in operation and the recording shall be kept available for a minimum of 31 days with time and date stamping. Recordings shall be made available to a duly authorised Hackney council officer or a police officer upon request. The CCTV system shall be operated in accordance with the data protection act 1998 and any other relevant legislation.

2. No less than one member of staff who is able to operate the CCTV system shall be on the premises whenever the premises is operational.

3. A minimum of one SIA registered door staff per 100 patrons to be employed at the venue after 2200hrs. Additional male and female SIA door staff to be employed at the premises when required on the basis of an operational risk assessment with identity badges displayed at all times and SIA numbers, full names, times worked and duty performed to be entered into an occurrence book and made available to police immediately upon request.

4. An incident log shall be kept at the premises and made available on request to an authorised officer of the council or the Police, which will record the following as a minimum;

- a) All crimes reported to the venue
- b) All ejections of patrons
- c) Any complaints received
- d) Any incidents of disorder
- e) Seizures of drugs or weapons
- f) Any CCTV faults, search equipment faults or scanning equipment faults
- g) Any refusal of the sale of alcohol
- h) Any visit by a relevant authority or emergency service

5. The licensee shall operate a zero tolerance policy to drugs and comply with the Hackney Police/Community Safety Unit Drugs and Weapons policy. Prominent signage highlighting zero tolerance to drugs and weapons shall be displayed at the entrance and within the premises.

6. The premises will maintain a written search policy to be operated within the premises, the aim of which is to deter customers from bringing illegal items, drugs and/or weapons into the premises.

7. A written record shall be kept detailing all refused sales of alcohol. The record should be kept on the premises, and made available for inspection on request by any duly authorised officer. Records should be kept for a minimum 12 months.

8. The licensee shall display the telephone and email address of the Designated Premises Supervisor for use by any person who may wish to make a complaint during the opening hours of the premises. The number/email address should be displayed in a prominent external location which is easily accessible to the public.

9. Staff must carry out regular, random toilet checks, at least once per hour when the premises is open to the public for evidence of any crime. These checks are to be documented and kept for a minimum 31 days and made available on request for inspection by the Police.
10. Customers will not be allowed to leave the premises with glass or any other open container,
11. There shall be no entry or re-entry to the premises after 0100hrs by members of the public save for those that have temporarily left the premises to smoke.
12. There shall be a written dispersal policy, a copy of which shall be kept on the premises and made available to police or authorised officer upon request.
13. Clear and prominent notices shall be displayed and maintained at all exits in a place where they can be seen and easily read by customers requesting them to leave the premises and the area quietly.
14. No more than 10 smokers will be permitted in the designated smoking area after 9pm.
15. The premises shall operate a challenge 25 scheme. Any person who appears to be under the age of 25 shall be asked to provide proof of age identification in the form of a passport, photo driving licence or PASS proof of age card. Failure to provide such identification will result in a refusal to sell alcohol and detailed in the refusals book.
16. Prominent, clear notices shall be displayed at the point of entry and in prominent areas around the premises outlining the Challenge 25 policy.
17. All staff will receive training in regards the relevant legislation relating to the sale of alcohol, particularly under age sales and sales to drunks. Records of such training will be maintained on the premises and refresher training will be carried out on a 6 to 12 month basis.
18. Reasonable steps to be taken to ensure an authorised person is a member of Pubwatch and SNOW, the membership is kept up to date and at least 3 meetings a year are attended.
19. All children to be accompanied by a responsible adult. Children to leave the premises by 1900hrs.
20. Premises to operate a no baseball caps or hooded tops policy and no alcohol promotions eg; Happy hour or 2 for 1.
21. Noise limiter to be employed in a separate and remote (from the volume control) lockable cabinet must be fitted to the music amplification system. No supplementary sound system to be used by acts without a full risk assessment and prior notice given to Hackney noise pollution department and Hackney Police.
22. Adequate/improved security lighting outside the premises with consideration being given to light pollution of neighbouring properties. All entrances to the venue to be lit and painted white to enable better quality of CCTV images for identification purposes.
23. The premises will also, in cooperation with Hackney Police and no later than 3 months following the granting of the premises licence, regularly facilitate a premises drug audit using the Ion Itemiser or similar device.
24. Queues to be supervised by doorstaff to prevent disorder and measures to be implemented aimed at discouraging anti-social behaviour.
25. Premises will provide the police with a dispersal policy and comply with its contents to ensure that all patrons leave the venue and the vicinity quickly and quietly. Notices to be

displayed at all exits requesting that patrons respect the needs of local residents and leave the premises and the area quietly.

26. All staff employed at the premises should be over 18 years old and photo identification has been seen to confirm this.

27. A member of staff shall run the cloakroom whenever licensable activities are taking place.

b) The prevention of crime and disorder

See A above

c) Public safety

See A above

d) The prevention of public nuisance

See A above

e) The protection of children from harm

See A above

Checklist:

Please tick to indicate agreement

- I have made or enclosed payment of the fee.
- I have enclosed the plan of the premises.
- I have sent copies of this application and the plan to responsible authorities and others where applicable.
- I have enclosed the consent form completed by the individual I wish to be designated premises supervisor, if applicable.
- I understand that I must now advertise my application.
- I understand that if I do not comply with the above requirements my application will be rejected.
- [Applicable to all individual applicants, including those in a partnership which is not a limited liability partnership, but not companies or limited liability partnerships] I have included documents demonstrating my entitlement to work in the United Kingdom or my share code issued by the Home Office online right to work checking service (please read note 15).

IT IS AN OFFENCE, UNDER SECTION 158 OF THE LICENSING ACT 2003, TO MAKE A FALSE STATEMENT IN OR IN CONNECTION WITH THIS APPLICATION. THOSE WHO MAKE A FALSE STATEMENT MAY BE LIABLE ON SUMMARY CONVICTION TO A FINE OF ANY AMOUNT.

IT IS AN OFFENCE UNDER SECTION 24B OF THE IMMIGRATION ACT 1971 FOR A PERSON TO WORK WHEN THEY KNOW, OR HAVE REASONABLE CAUSE TO BELIEVE, THAT THEY ARE DISQUALIFIED FROM DOING SO BY REASON OF THEIR IMMIGRATION STATUS. THOSE WHO EMPLOY AN ADULT WITHOUT LEAVE OR WHO IS SUBJECT TO CONDITIONS AS TO EMPLOYMENT WILL BE LIABLE TO A CIVIL PENALTY UNDER SECTION 15 OF THE IMMIGRATION, ASYLUM AND NATIONALITY ACT 2006 AND PURSUANT TO SECTION 21 OF THE SAME ACT, WILL BE COMMITTING AN OFFENCE WHERE THEY DO SO IN THE KNOWLEDGE, OR WITH REASONABLE CAUSE TO BELIEVE, THAT THE EMPLOYEE IS DISQUALIFIED.



Part 4 – Signatures (please read guidance note 11)

Signature of applicant or applicant’s solicitor or other duly authorised agent (see guidance note 12). **If signing on behalf of the applicant, please state in what capacity.**

Declaration	<ul style="list-style-type: none">• [Applicable to individual applicants only, including those in a partnership which is not a limited liability partnership] I understand I am not entitled to be issued with a licence if I do not have the entitlement to live and work in the UK (or if I am subject to a condition preventing me from doing work relating to the carrying on of a licensable activity) and that my licence will become invalid if I cease to be entitled to live and work in the UK (please read guidance note 15).• The DPS named in this application form is entitled to work in the UK (and is not subject to conditions preventing him or her from doing work relating to a licensable activity) and I have seen a copy of his or her proof of entitlement to work, or have conducted an online right to work check using the Home Office right to work checking service which confirmed their right to work (please see note 15)
Signature	
Date	22/12/2021
Capacity	Solicitor/Partner

For joint applications, signature of 2nd applicant or 2nd applicant’s solicitor or other authorised agent (please read guidance note 13). **If signing on behalf of the applicant, please state in what capacity.**

Signature	
Date	
Capacity	

Contact name (where not previously given) and postal address for correspondence associated with this application (please read guidance note 14) Dadds LLP 			
Post town		Postcode	

Telephone number (if any)	██████████
If you would prefer us to correspond with you by e-mail, your e-mail address (optional)	██████████

Notes for Guidance

1. Describe the premises, for example the type of premises, its general situation and layout and any other information which could be relevant to the licensing objectives. Where your application includes off-supplies of alcohol and you intend to provide a place for consumption of these off-supplies, you must include a description of where the place will be and its proximity to the premises.
2. In terms of specific regulated entertainments please note that:
 - Plays: no licence is required for performances between 08:00 and 23.00 on any day, provided that the audience does not exceed 500.
 - Films: no licence is required for 'not-for-profit' film exhibition held in community premises between 08.00 and 23.00 on any day provided that the audience does not exceed 500 and the organiser (a) gets consent to the screening from a person who is responsible for the premises; and (b) ensures that each such screening abides by age classification ratings.
 - Indoor sporting events: no licence is required for performances between 08.00 and 23.00 on any day, provided that the audience does not exceed 1000.
 - Boxing or Wrestling Entertainment: no licence is required for a contest, exhibition or display of Greco-Roman wrestling, or freestyle wrestling between 08.00 and 23.00 on any day, provided that the audience does not exceed 1000. Combined fighting sports – defined as a contest, exhibition or display which combines boxing or wrestling with one or more martial arts – are licensable as a boxing or wrestling entertainment rather than an indoor sporting event.
 - Live music: no licence permission is required for:
 - a performance of unamplified live music between 08.00 and 23.00 on any day, on any premises.
 - a performance of amplified live music between 08.00 and 23.00 on any day on premises authorised to sell alcohol for consumption on those premises, provided that the audience does not exceed 500.
 - a performance of amplified live music between 08.00 and 23.00 on any day, in a workplace that is not licensed to sell alcohol on those premises, provided that the audience does not exceed 500.
 - a performance of amplified live music between 08.00 and 23.00 on any day, in a church hall, village hall, community hall, or other similar community premises, that is not licensed by a premises licence to sell alcohol, provided that (a) the audience does not exceed 500, and (b) the organiser gets consent for the performance from a person who is responsible for the premises.
 - a performance of amplified live music between 08.00 and 23.00 on any day, at the non-residential premises of (i) a local authority, or (ii) a school, or (iii) a hospital, provided that (a) the audience does not exceed 500, and (b) the organiser gets

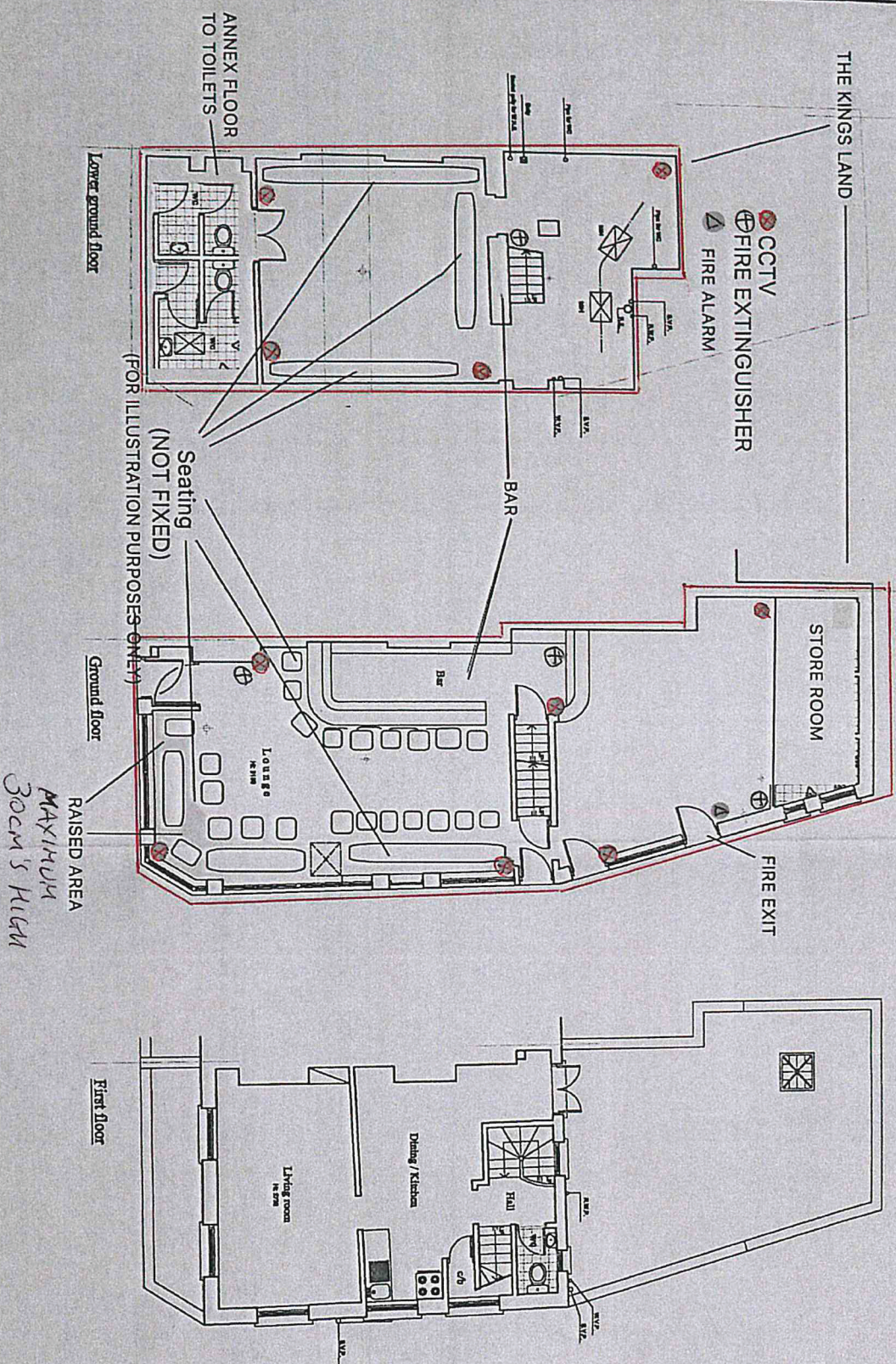

Brookland Architects
 19, Poplar Road, London, N11 5DP
 Telephone: 020 2014 1109
 Fax: 020 2014 2424

NOTES
 The information on this sheet is for the proposed work only and is not intended to be used for any other purpose. It is the responsibility of the client to ensure that the information is correct and that the proposed work is carried out in accordance with the relevant regulations and standards. The architect is not responsible for any errors or omissions in the information provided on this sheet.

PROJECT
 267, KINGSLAND ROAD,
 LONDON E8

DRAWING TITLE
 EXISTING
 FLOOR PLANS

DRAWN BY: G. B. Allen
SCALE: 1/50-1/100
REF. NO.: 010314-01

APPENDIX B1

RESPONSIBLE AUTHORITY REPRESENTATION: APPLICATION UNDER THE LICENSING ACT 2003

RESPONSIBLE AUTHORITY DETAILS

NAME OF AUTHORITY	Metropolitan Police service
ADDRESS OF AUTHORITY	Licensing Unit, Stoke Police Station 33 Stoke Newington High Street London N16 8DS
CONTACT NAME	PC 3691CE Kerrie RYAN
TELEPHONE NUMBER	07796 183078
E-MAIL ADDRESS	hackneylicensing@met.police.uk

APPLICATION PREMISES

NAME & ADDRESS OF PREMISES	The Kings Land 267 Kingsland Road London E2 8AS
NAME OF PREMISES USER	TKL INC Ltd

COMMENTS

I make the following relevant representations in relation to the above application to vary the Premises Licence at the above address.

- 1) the prevention of crime and disorder
- 2) public safety
- 3) the prevention of public nuisance
- 4) the protection of children from harm

Representations (which include comments and/or objections) in relation to:

Police make the following representations in relation to the application for a Premises Licence at THE KINGS LAND, 267 KINGSLAND ROAD, LONDON, E2 8AS for the following reason(s);

This premises is located on a busy main road between Dalston and Shoreditch. This premises has previously held a premises licence, but was a huge crime generator and was the subject of many resident complaints in relation to noise and ASB.

Since the surrender of this licence there has been a noticeable change in the area. Police found that the late hours of this venue were attracting customers from Shoreditch who were looking for another place to go to continue drinking and socialising, and then if entry was denied, they would loiter on the street creating noise and ASB.

Prior to this application being submitted police attended a meeting with the applicants at the venue. It came to light during this conversation that the applicant and his partner had committed to the lease of this premises without checking the status of the Premises Licence. Police were very clear that we would not support a late night venue that sought hours later than core hours, so we were surprised to see that this application seeks 0300hrs Sunday to Wednesday and 0500hrs at weekends despite our conversation.

During the consultation period of this application, the premises have operated on TENS. On New Years Eve, the venue opened on a TEN which authorised the sale of alcohol and regulated entertainment until 0100hrs. When police arrived at the venue at 0115hrs, the venue was still open with people inside and the band playing – amounting to unlawful licensable activity. Police spoke with the SIA Door Supervisor, who when asked what time the premises was closing, said that he had been told 2am. Police then spoke with Ismail TEZGEL, who was the person in charge, and he stated that ‘they were closing slowly now’. He also stated that he didn’t know that the live band was licensable activity, which police found particularly concerning. He also told us that his partner, Hande SEZGIN, had told him that he did not have to close at the time stated on the TEN and that he just had to turn the music down.

This is not the only licensed premises that the applicants have in the area, so it is a concern that basic knowledge of licensable activity and the definition of regulated entertainment is missing. The applicant has had a history of breaching conditions at another of their venues, which was reviewed by LBH, and their actions on this occasion does not satisfy police that they will be a responsible operator here.

Police look forward to hearing from the applicant soon to discuss a way forward for this application.

The above representations are supported by the following evidence and information.

Personal knowledge of the local area and issues in the area.

Are there any actions or measures that could be taken to allay concerns or objections? If so, please explain.

Signed
PC 3691CE RYAN

(By E-mail)
Name (printed)

APPENDIX B2

RESPONSIBLE AUTHORITY REPRESENTATION: APPLICATION UNDER THE LICENSING ACT 2003

RESPONSIBLE AUTHORITY DETAILS

NAME OF AUTHORITY	Licensing Authority
ADDRESS OF AUTHORITY	Licensing Service 1 Hillman Street London E8 1FB
CONTACT NAME	Channing Riviere
TELEPHONE NUMBER	020 8356 4622
E-MAIL ADDRESS	Channing.riviere@hackney.gov.uk

APPLICATION PREMISES

NAME & ADDRESS OF PREMISES	The Kings Land 267 Kingsland Road Hackney London E2 8AS
NAME OF APPLICANT	TKL Inc. Ltd.

COMMENTS

I make the following relevant representations in relation to the above application.

- the prevention of crime and disorder
- public safety X
- the prevention of public nuisance X
- the protection of children from harm

Representations (which include comments and/or objections) in relation to:

Having reviewed the application the Licensing Authority submit the following comments.

Application describes the site as a public house. However the activities being sought and the lack of late night refreshment and a kitchen suggest the site will be solely as a nightclub. The premises was previously used as a nightclub before the surrender of the licence. Additionally the premises seeks to continue the sale of alcohol up until the closure of the premises.

The proposed hours are well in excess of those set in LP3 (Core Hours)

The site previously operated under the name "Shelter". The operation of the site led to significant negative impact on the immediate vicinity and local residents. A number of visits were made to the site prior to the onset of the pandemic to tackle problems as a result of the operation. Local residents raised a number of complaints about the operation of the premises and subsequent ASB that would arise from the patrons of the premises loitering in the area and failing to disperse from the premises, the local vicinity became a hot spot for NOS sellers and other forms of ASB. A further example of the ASB generated by the premises can be found in a report received by licensing officers below.

"ATTEMPTED GBH- CAD 1103/23 – Group of males have an altercation outside Shelter Club, 267 Kingsland Road. 1 Male pulls out a metal object, believed to be a crowbar out of the boot and attempts to attack another before security intervened. Group of males then enter a dark-coloured BMW and drive away before doing a U-TURN and intentionally mounting the pavement and skittling members of the public. The vehicle drives on and does another U-TURN before mounting the pavement again and hitting members of the public and driving away.

3 injured members of the public, all with ABH levels on injuries. It appears the 3 injured are not the intended targets.

The venue states that the suspects were all in the club and used the driving licence to get in which has been recorded on their systems. Suspect details have been obtained and the investigation is ongoing. CRIS in the process of being put on."

The licensee at the time attended intervention meetings. That licence was surrendered in 2020.

The plan attached to the application is poor quality and has been poorly drafted. The plan at present shows toilets that appear to be inaccessible.

We have concerns around those who will be operating the site as they are known to operate a nearby premises on Orsman Road which regularly receives complaints which led to the revocation of the licence and subsequent dismissal of the appeal. We note from the representation submitted by the Police that the proposed DPS mentions his partner as a Hande SEZGIN. This is the former licensee of the premises located at nearby Orsman Road.

Given our experience with this individual, we have little confidence in their ability to manage licensed premises, the licence of the premises located at Orsman Road includes a condition on the premises licence to exclude this individual from the premises. As far as we are aware Hande SEZGIN is liable for the payment of legal costs of approximately £15,000 to the London Borough of Hackney.

Overall, there is nothing in the application that gives any comfort that the problems that occurred when the site operated as Shelter would not reemerge.

The above representations are supported by the following evidence and information.

The Licensing Act 2003, Statement of Licensing Policy 2016 and Guidance issued by the Home Office. Experience of the previous operation of this venue.

Are there any actions or measures that could be taken to allay concerns or objections? If so, please explain.

The applicants will need to consider stringent measures to manage any dispersal and ASB arising from patrons of the premises.
The applicants should also consider reducing the hours sought to core hours outlined in the Council's licensing policy (LP3).

Name: Channing Riviere (Principal Licensing Officer)

Date: 19/01/2022

**RESPONSIBLE AUTHORITY REPRESENTATION:
APPLICATION UNDER THE LICENSING ACT 2003****RESPONSIBLE AUTHORITY DETAILS**

NAME OF AUTHORITY	London Borough of Hackney
ADDRESS OF AUTHORITY	Community Safety & Enforcement Service First Floor Hackney Service Centre 1 Hillman Street London E8 1DY
CONTACT NAME	Jacey Frewin
TELEPHONE NUMBER	020 8356 4567
E-MAIL ADDRESS	jacey.frewin@hackney.gov.uk

APPLICATION PREMISES

NAME & ADDRESS OF PREMISES	The Kings Land, 267 kingsland Road London E2 8AS
NAME OF APPLICANT	TKL INC Limited

COMMENTS

I make the following relevant representations in relation to the above application to vary the Premises Licence at the above address.

- 1) the prevention of crime and disorder •
- 2) public safety •
- 3) the prevention of public nuisance **x**
- 4) the protection of children from harm •

Representation in relation to:

ENVIRONMENTAL LICENCE CONDITIONS IN RESPECT OF

**The Kings Land
267 kingsland Road, London E2 8AS**

1. The Licensee shall ensure that all relevant staff are fully trained and made aware of the legal requirement of businesses to comply with their responsibility as regards the disposal of waste produced from the business premises. The procedure for handling and preparing for disposal of the waste shall be in writing and displayed in a prominent place where it can be referred to at all times by staff.
2. The Licensee shall ensure that any contract for general and recyclable waste disposal shall be appropriate in size to the amount of waste produced by the business. The Licensee shall maintain an adequate supply of waste receptacles provided by his registered waste carrier (refuse sacks or commercial waste bins) in order to ensure all refuse emanating from the business is always presented for collection by his waste carrier and shall not use any plain black or unidentifiable refuse sacks or any other unidentifiable or unmarked waste receptacles.
3. The Licensee's premises are situated in an area within which refuse may only be left on the public highway at certain times (time bands). If the Licensee's waste carrier cannot or does not comply by collecting the refuse within an hour after the close of any time band imposed by the waste authority, the Licensee must remove the refuse from the public highway and/or keep it within the premises until such time as his/her waste carrier arrives to collect the refuse.
4. The Licensee shall instruct members of staff to make regular checks of the area immediately outside the premises and remove any litter, bottles and glasses emanating from the premises. A final check should be made at close of business.
5. The Licensee shall provide a safe receptacle for cigarette ends to be placed outside for the use of customers, such receptacles being carefully placed so as not to cause an obstruction or trip.
6. The current trade waste agreement/duty of care waste transfer document shall be conspicuously displayed and maintained in the window of the premises where it can be conveniently seen and read by persons standing in The Kings Land. This should remain unobstructed at all times and should clearly identify:-
 - the name of the registered waste carrier
 - the date of commencement of trade waste contract
 - the date of expiry of trade waste contract
 - the days and times of collection
 - the type of waste including the European Waste Code

The above representations are supported by the following evidence and information.

We have received complaints in the past regarding littering and build-up of waste in the area. There have been instances in the past where Enforcement Officers have found evidence of the illegal disposal of waste from businesses in this area. Experience has also shown that there is the probability that there will be cigarette litter outside these premises due to the smoking ban.

Are there any actions or measures that could be taken to allay concerns or objections? If so, please explain.

contact Jacey Frewin by email

Name: Jacey Frewin

Date: 11/01/2022

APPENDIX C1**TKL Inc licence application - 267 Kingsland Road - Representations**

1 message

30 December 2021 at 11:29

[REDACTED]
To: licensing@hackney.gov.uk

Dear all,

I am writing in respect of an application made under the Licensing Act 2003 by TKL INC Ltd in respect of the premises at 267 Kingsland Road. I am a resident living in Archer House on Phillipp Street which is very close to the premises and would therefore like to make the following representations in respect of this application:

1. Operating hours - I am extremely concerned about the proposed operating hours for this new club/bar. The proposal is for the club to be open and serving alcohol until 3am four nights per week and to be open and serving alcohol until 5am three nights a week. This is excessive and will result in drunk and disorderly behaviour right on our doorstep and on a busy road. To have a club on my doorstep that is serving so late into the night seven days a week will damage the peaceful atmosphere of the area and I would ask that curbs on these operating hours are considered. Equally concerning is that the licence includes a request for extended hours on notable days when the hours are already extremely broad.
2. No operating history - TKL INC Ltd appears to be a newly formed private limited company that has no operating experience. The appropriateness of permitting a license with such excessive operating hours to a company that has no history or experience whatsoever must be considered.
3. Anti-social behaviour - The club was previously called 'Shelter' and during the course of its operation we would routinely find a huge number of nitrous oxide canisters on our road all around the corner on which the premises are situated. We would also have damage to our bin areas and people urinating or being sick in these areas late into the night. During the pandemic, the premises have been empty/closed and we have had peace, quiet and tranquility with nowhere near as many issues with anti-social behaviour, drunken behaviour, nitrous usage etc - it is such a shame to see the venue reopening as a club with such late hours when we have had the benefit of it being shut for the last year and a half. I am deeply concerned about the risk of all this behaviour returning to my street as soon as this new club opens, especially with its seven day a week 3am/5am alcohol licence.
4. Noise - similar to the above concerns, it is excessive to permit live music to be played seven days a week until midnight and recorded music until 2.30am or 4.30am depending on the day of the week - are any soundproofing or decibel limiters going to be put into effect? When the club was previously known as Shelter we would frequently be able to hear the loud music playing until late into the night and we are extremely conscious of the risk that this will now return.

Many thanks,

[REDACTED]

King's land noise

1 message

16 January 2022 at 08:39

To: licensing@hackney.gov.uk

Dear Licensing Committee

I write with concern in regard to the application for the due for consideration this Wednesday 19/1/22 in regard to the [King's Land, 267 Kingsland Road E2](#).

I am a resident of Arrow House on the Whitmore Estate which sits directly behind the bar. As the Head of Licensing and previous Cllr for Community Safety, Caroline Selman will remember, the Canalside Residents Association organised a meeting with the Council in 2019 to discuss our concerns around noise, crime and serious incidents of antisocial behaviour and the difficulties of policing the night time economy on this small strip, and Phillip Street, were acknowledged. We are aware as residents of Hackney the Council is generally concerned about these impacts, yet this particular area appears to be an exception when compared to Dalston and Shoreditch, both in policing and Council concern about the impact on residents' mental health and wellbeing. There are a number of families with young children in the immediate area, particularly in Arrow and Fletcher Houses and above the Whitmore Community Centre, and the hostel at [255 Kingsland Road](#), alongside key workers. People's sleep is not only disturbed by noise but we are often greeted by the aftermath on Saturday Sunday mornings - vomit, nitrous canisters etc, particularly where Phillip Street meets Kingsland Road. These regular unpleasant consequences were also matched with regular incidents the Council was aware of.

While COVID has had what we can assume is a temporary impact, there has been an increase in the number of bars open until 5am, with a licence granted to the bar in the former Cafe Floria. The Head of Licencing explained to us it was very difficult to alter licensing once issued and yet there still seems no plan to manage the cumulative impact of late night licences on the immediate area, as there are in larger town centres in Hackney.

I would urge this licence to be considered with a wider understanding of the levels of disruption the cluster of late night licences on this densely populated stretch of Kingsland Road has meant for residents. For that reason may I request the 5am licence is either reduced to an earlier time, to stagger the potential for anti-social behaviour, or not granted before comprehensive published plans from the Council to mitigate the impacts on residents.

The Hackney Gazette previously covered the frustrations residents have had: <https://www.hackneygazette.co.uk/news/crime/kingsland-road-has-become-clubbing-district-for-people-leaving-shoreditch-3633618>

Thank You

Arrow House
N1 

OFFICIAL - SENSITIVE Objection to licence for E2 8AS

1 message

16 January 2022 at 10:18

To: "licensing@hackney.gov.uk" <licensing@hackney.gov.uk>



Cc: "mayor@hackney.gov.uk" <mayor@hackney.gov.uk>, "meg.hillier.mp@parliament.uk" <meg.hillier.mp@parliament.uk>

Dear Sir/Madam,

I am writing to object to the reopening of the venue formerly called Shelter. I object to the licence application being made for **The King's Land, 267 Kingsland Road, E2 8AS** **9t on behalf of TKL INC Ltd.**

My balcony overlooks this venue's backyard. I have witnessed intimate scenes being undertaken openly, in addition to multiple examples of rowdy behaviour. It is unpleasant and impedes sleep.

Kind regards,

Fletcher Houe, N1 

Application consideration scheduled 19/1/2022

1 message

15 January 2022 at 12:34

Reply-To: [REDACTED]
To: licensing@hackney.gov.uk

Dear Licensing Committee,

I write with regard to the application for due consideration, scheduled for 19/1/22 to the [King's Land, 267 Kingsland Road E2](#).

I am a resident at Whitmore House on the Whitmore Estate. I can confirm that I and many other residents met with Caroline Sellman in recent past via the Canalside Residents Association around 2019 to discuss our concerns around noise, crime and serious incidents of antisocial behaviour and the difficulties of policing the night time economy. This was acknowledged as a problem and the impact it had on residents in the area was well documented. The ASB issues affected so many people in the local area along with drug related issues and aggression to residents that followed.

To now learn that LBH licensing committee will be considering an application for another club to open late into the early morning hours raises concerns to me and I believe many other residents on the Whitmore Estate. Resident will have to deal with the "real consequences" of ASB that is highly likely to follow if this application is successful.

On this basis I want to raise objection to this application and I place responsibility on the Licensing Committee to weigh up the issues as to what is in the best interest **for all residents living** in the area.

Agreeing any licence request for 5am should not be considered due to ASB. I want to know how the Licensing Committee will mitigate the impact to residents so our health and well being is protected

I will draw to your attention the link below

The Hackney Gazette previously covered the frustrations residents have had: <https://www.hackneygazette.co.uk/news/crime/kingsland-road-has-become-clubbing-district-for-people-leaving-shoreditch-3633618>

This should not happen again and residents should be able to live a decent quality of life. Failure to take the right action will contribute to further future misery for residents - this must not happen!

I look forward to know more as to how the Licensing Committee will make their determination about this application and how they will consult openly with my concerns and those of residents in the local area

I expect a response back from the Licensing Committee to my email

[REDACTED]

[REDACTED] Whitmore House

[REDACTED] [Nuttall Street N1](#) [REDACTED]

Representation: King's Land, 267 Kingsland Road E2

1 message

17 January 2022 at 16:45

To: "Licensing (Shared Mailbox)" <licensing@hackney.gov.uk>

Dear Licensing Committee

I write with concern in regard to the application for the due for consideration this Wednesday 19/1/22 in regard to the [King's Land, 267 Kingsland Road E2](#).

I am a resident of Arrow House on the Whitmore Estate which sits directly behind the bar. As the Head of Licensing and previous Cllr for Community Safety, Caroline Selman will remember, the Canalside Residents Association organised a meeting with the Council in 2019 to discuss our concerns around noise, crime and serious incidents of antisocial behaviour and the difficulties of policing the night time economy on this small strip, and Phillipp Street, were acknowledged. We are aware as residents of Hackney the Council is generally concerned about these impacts, yet this particular area appears to be an exception when compared to Dalston and Shoreditch, both in policing and Council concern about the impact on residents' mental health and wellbeing. There are a number of families with young children in the immediate area, particularly in Arrow and Fletcher Houses and above the Whitmore Community Centre, and the hostel at [255 Kingsland Road](#), alongside key workers. People's sleep is not only disturbed by noise but we are often greeted by the aftermath on Saturday Sunday mornings - vomit, nitrous canisters etc, particularly where Phillipp Street meets Kingsland Road. These regular unpleasant consequences were also matched with regular incidents the Council was aware of.

While COVID has had what we can assume is a temporary impact, there has been an increase in the number of bars open until 5am, with a licence granted to the bar in the former Cafe Floria. The Head of Licencing explained to us it was very difficult to alter licensing once issued and yet there still seems no plan to manage the cumulative impact of late night licences on the immediate area, as there are in larger town centres in Hackney.

I would urge this licence to be considered with a wider understanding of the levels of disruption the cluster of late night licences on this densely populated stretch of Kingsland Road has meant for residents. For that reason may I request the 5am licence is not granted without comprehensive plans from the Council to mitigate the impacts on residents.

The Hackney Gazette previously covered the frustrations residents have had: <https://www.hackneygazette.co.uk/news/crime/kingsland-road-has-become-clubbing-district-for-people-leaving-shoreditch-3633618>

Thank You

Arrow House, N1

Objection To License Application (The King's Land (formerly Shelter), 267 Kingsland Road, E2 8AS on behalf of TKL INC Ltd)

1 message

17 January 2022 at 17:19

To: "licensing@hackney.gov.uk" <licensing@hackney.gov.uk>

Cc: "mayor@hackney.gov.uk" <mayor@hackney.gov.uk>, "meg.hillier.mp@parliament.uk" <meg.hillier.mp@parliament.uk>

Dear Sir/Madam,

I am writing to object to the licence application being made for The King's Land (formerly Shelter), [267 Kingsland Road, E2 8AS](#) on behalf of TKL INC Ltd.

Prior to the first Covid lockdown there were unacceptable levels of night-time anti-social behaviour, crime and noise pollution in the street outside the block where I live. This was a direct result of several venues on a short stretch of road operating licenses until 5am. The busiest and noisiest of these was the club formerly called Shelter. At the time it was impossible to get uninterrupted sleep at the weekend because of the noise from car stereos, people fighting, shouting and screaming. Walking out one morning to find that the road had been cordoned off by police because of a stabbing was a particularly low point.

I'm afraid that granting 5am licenses to any of these clubs will mean an immediate rise in criminal and antisocial behaviour on my doorstep. Historically none of the clubs on this stretch of Kingsland Road have made any serious attempt to mitigate the effects of having hundreds of people drinking and using drugs in such a small area.

The situation here prior to the first Covid lockdown was so bad it was featured in the local news:

<https://www.hackneygazette.co.uk/news/crime/kingsland-road-has-become-clubbing-district-for-people-leaving-shoreditch-3633618>



Kingsland Road has become 'clubbing district' for people leaving Shoreditch say fed up neighbours | Hackney Gazette

Tony, whose family have owned their business for 42 years, says he and his neighbours are getting no help from the authorities. In one video, filmed at 5.05am on June 29, a police van can be seen driving slowly up Kingsland Road, straight past a group of 50 or 60 people on the pavement.

Thank you for your time.

Yours,

[REDACTED]

[REDACTED] Fletcher House

[REDACTED] Nuttal St

London

N1 [REDACTED]

Objection to license application for The Kings Land

1 message

17 January 2022 at 20:42

To: licensing@hackney.gov.uk

Cc: mayor@hackney.gov.uk, meg.hillier.mp@parliament.uk

Dear Sir/Madam,

I am writing as a resident of [REDACTED] Fletcher House, [REDACTED] Nuttall St, London N1 [REDACTED], to object to the reopening of the venue formerly called Shelter Club London, I object to the license application being made for **The King's Land, 267 Kingsland Road, E2 8AS** on behalf of **TKL INC Ltd**. My objection is based on the nature of the license (late hours and alcohol off premise), the geographical location of the premises being conducive to concentration of crime, ASB and noise pollution and thirdly a question on the suitability of the applying business of managing a premise with such a license.

I recently moved to the area and plan to raise a family here, and am worried about the potential for public nuisance and risk of crime, anti-social behaviour given the extension of operating hours beyond those of comparable venues in Shoreditch and extremely concerning sale of alcohol off-premises. I have been made aware of frequent instances of anti-social behaviour, crime and noise pollution generated by several venues in the area before the lockdown: <https://www.hackneygazette.co.uk/news/crime/kingsland-road-has-become-clubbing-district-for-people-leaving-shoreditch-3633618>, and the relevant Crime Chief in this article is acknowledging issues especially concentrated in this location. The stretch around **267 Kingsland Road** is extremely narrow, with a mosque and close building front to one side, and other side leading straight into residential areas - meaning overspilling crowds are extremely likely to congregate on the streets or into the space leading to Whitmore Estate (and this can already be witnessed nowadays with noisy crowds and public urination on Wilmore Gardens, which is directly facing towards Fletcher House).

With a license expanding to after-hours compared to many venues in Dalston and Shoreditch our local neighborhood risks drawing especially drunken and late-night revellers crowds, which exponentially increases the likelihood of crimes, anti-social behaviour and noise pollution. With noise levels expected to peak at the end of opening hours this will be incredibly disruptive to the sleep of us neighbors, many of whom work local jobs in the community and are families with young children. There are already other venues open in the area and granting another license would negatively affect the well-being and safety of nearby residents.

The previous club at the same location, the Shelter Club, I understand was not able to implement any sort of proper crowd or noise management and had to close. I am surprised that TKL Inc., the company currently applying for the license has their nature of business on Companies House listed as "55209 - Other holiday and other collective accommodation" (<https://find-and-update.company-information.service.gov.uk/company/12483544>) which makes me concerned about the business model in place here. It also makes me concerned about whether this company is suitable in running a club in this location given the above issues that it will need to mitigate as it doesn't seem to be better set up or more experienced in managing a club than previous owners.

I am looking forward to your careful consideration of these objections and those of my other neighbours and remain at your disposal.

Thank you very much,

[REDACTED]
Fletcher House
Nuttall Street
N1 [REDACTED].

Representation re licensing application 267 Kingsland Road

1 message

18 January 2022 at 15:50

To: "licensing@hackney.gov.uk" <licensing@hackney.gov.uk>
Cc: "steve.race@hackney.gov.uk" <steve.race@hackney.gov.uk>, "kam.adams@hackney.gov.uk" <kam.adams@hackney.gov.uk>, "susan.fajanathomas@hackney.gov.uk" <susan.fajanathomas@hackney.gov.uk>

Dear Licensing Committee,

I am writing to you on behalf of the Canalside Residents' Association (CRA) to make a representation to object to the licence application being granted for The [King's Land, 267 Kingsland Road, E2 8AS](#) 9t on behalf of TKL INC Ltd.

The problems caused by nightclubs in the small area along Kingsland Road is well known to the Council, the Police, and especially to the residents of this area. In 2019, the CRA hosted a meeting attended by local Councillors, Caroline Selman (then Head of Licensing), officials from Hackney Council, and many local residents. At the meeting, local residents expressed the unacceptable level of disturbance that nightclubs were causing in the small hours. They clearly demonstrated that the licensing objectives (the prevention of crime and disorder, the prevention of public nuisance, public safety, and the protection of children from harm) were not being met. There was

crime and disorder (drug dealing, a stabbing amongst them),

public nuisance caused by people exiting the clubs to congregate on the pavement taking the noise to a level that it awakened, and upset, sleeping residents, including children.

public safety issues with frequent fights breaking out, near miss traffic accidents, and even an 'attack dog' brought to the area where it was let loose to attack someone

protection of children from harm was violated by many broken nights' sleep causing them not to be alert the following day and nitrous oxide capsules littering the road and pavements which children found on their way to school the next morning, and the effect all this has on their mental health and well-being.

Obviously, residents living closest to the area (Whitmore House, Nightingale House, Fletcher House, Arrow House and Bolt House, all of which are on the Whitmore Estate), and others living in the hostel at [255 Kingsland Road](#), in addition to residents who live above the commercial premises. However, the effects are also felt further away, as children and adults have to walk through the aftermath (litter, vomit and the smell of urine) on their way to school, work or to visit the shops on that area of Kingsland Road. In addition, people leaving the clubs walk through local streets, often stopping to congregate en route, shouting, sometimes arguing and relieving themselves along the way. Residents have videos of the mayhem caused.

Hackney Council is well aware of these problems and the distress they cause to families, key workers and elderly people.

On behalf of the Canalside Residents' Association, which represents residents on the Whitmore estate, I implore the Licensing Committee to reject this application. There are already new late-night venues open in this small area, another one would be disastrous for residents' quality of life.

Please let me know that you have received this representation.

Acting Chair of Canalside Residents' Association.

[Watson's House](#), [Nuttall Street](#), N1

Raising an objection to a licensing act application

1 message

18 January 2022 at 17:35

[REDACTED]
To: licensing@hackney.gov.uk

To whom it may concern,

I would like to raise a strong objection to an application made under the Licensing Act 2003 on behalf of The King's Land (address: [267 Kingsland Road, E2 8AS](#).) The application is for a premises licence for live music from 12:00 to 00:00 Mon-Sun, recorded music from 12:00 to 2:30am Sun to Wed, and from 12:00 to 4:30am Thurs to Sat. They have also requested to supply alcohol from 12:00 to 3:00am Sun to Wed and from 12:00 to 5:00am Thurs to Sat.

As you may already know, this venue was, until very recently, called Shelter, and has had numerous complaints made about it over the past few years for nuisance behaviour from its clientele, incredibly loud music late into the night, blatant drug-taking in and outside of the premises, and a trail of vomit, broken beer bottles, and aggressive people the length of the street. This road is not exclusively a commercial road by any means. People live here, many of whom have young families and many of whom are essential workers. When the pandemic was at its height, the streets were safer and cleaner (I have lost count of the amount of times I have had to clean vomit off my doorstep or tidy away mounds of gas canisters and broken bottles outside my door.) The screaming and fighting that always accompanies this late licensing is unbearable, and certainly not possible to sleep through. Providing this licence would be tantamount to making the area unsafe and frankly uninhabitable for actual Hackney residents. I implore you to deny this application on the grounds of public safety, prevention of crime and disorder, and prevention of public nuisance.

Many thanks,

[REDACTED]
Kingsland Road Resident.

Objection to Licence Application

1 message

18 January 2022 at 18:21

To: "Licensing (Shared Mailbox)" <licensing@hackney.gov.uk>

Dear Licensing Committee,

I would like to make an objection to the current licence application made on behalf of The [King's Land, 267 Kingsland Road, E2 8AS](#), by TKL INC Ltd.

I live at [Kingsland Road](#) and have been a resident of the area for nearly ten years. I am extremely concerned about the harmful consequences to myself and the community that will result if this application is granted.

There are already a number of premises in this immediate area that open late and serve alcohol, including two directly opposite the premises in question, both of which open until 5am. A few years ago residents engaged in a meeting with members of the council and a representative of the police to discuss the shocking levels of anti-social behaviour, noise pollution and crime that were arising as a direct result of there being so many late-night establishments in such a small area. At that time, [267 Kingsland Road](#) was occupied by Shelter, which opened until 5am. Councillor Caroline Selman conceded that too many licenses had been granted in the area and expressed genuine concern for residents' well-being. The police made it clear that they were also concerned, having been called to the area on numerous occasions to deal with serious criminal activity. I can myself remember walking out of my building one morning and finding myself literally within a police cordon, because there had been a stabbing on the road outside late at night. It made me terrified to return to my building at any time after dark, especially on a Friday or Saturday. Noise pollution, too, was at a level that made my life unbearable. More often that I care to remember, cars were parked outside my building with the stereo turned up to a level that made it impossible to sleep - and all this from around 2am to well after 5am. The street itself became a place for people to drink, take drugs, dance and urinate (and worse). Please look at the video and images embedded in this article in the Hackney Gazette, which reported on the problem, and imagine that this was the scene in the early hours outside your building from Wednesday to Sunday:

<https://www.hackneygazette.co.uk/news/crime/kingsland-road-has-become-clubbing-district-for-people-leaving-shoreditch-3633618>

The fact that these levels of crime and anti-social behaviour virtually disappeared during the pandemic makes it obvious that they were linked to the heavy concentration of late-night establishments in the area. I feel sick at the prospect of having to live with these problems again. Like all the people who live here, I did not expect, when I moved, to end up living in the middle of a permanent all-night street party with endemic crime problems, but that is what the area became. I have spoken to many of my neighbours and can assure you that every single one of them is deeply, deeply concerned at the prospect of a late license being granted to the premises on [267 Kingsland Road](#). I ask that the council consider fully the rights of the residents, many of whom are elderly and/or have families. There is already a thriving night-time economy in this neighborhood. To allow yet another establishment to operate late at night would be to invite the kind of disruption and chaos that enveloped this street in the years leading up to the pandemic and made local lives miserable. I urge the council to deny the application.

Thank you,

[Kingsland Road](#)
E2

shelter reopening objection

1 message

19 January 2022 at 18:28

[REDACTED]
To: licensing@hackney.gov.uk
Cc: mayor@hackney.gov.uk, Meg Hillier MP <meghilliermp@parliament.uk>

Dear Sir/Madam,

My name is [REDACTED] and I am a constituent of South Hackney, address:

[REDACTED] Fletcher House
Nuttall Street
Hackney
London
N1 [REDACTED]

I am writing to object to the reopening of the venue formerly called Shelter, I object to the licence application being made for **The King's Land, 267 Kingsland Road, E2 8AS 9t on behalf of TKL INC Ltd.**

Our building is positioned directly behind the Kingshead pub which, before lockdown, operated a license until 5am and caused considerable disruption to residents sleep at night. In addition, because of chronic anti-social behaviour, crime and noise pollution generated by several venues in the area meant that residents from our block struggled immensely to with sleep deprivation due to noise.

It has had a serious impact on our mental health and general well-being and residents have rallied to raise awareness to the council and the police who I know were looking closely at this area before the first lockdown.

The council is/was aware it had granted too many late night licences in this area and still there is a new bar opposite us open until 5am, and there seems to be no effort to control the crowd outside.

Please see one local resident's account of their experience in this article: <https://www.hackneygazette.co.uk/news/crime/kingsland-road-has-become-clubbing-district-for-people-leaving-shoreditch-3633618>

We would like you to take seriously the objection by local residents to re-opening this venue.

Many thanks for your time in reading this.

Regards

[REDACTED]

Ward Cllr Objection to licensing application - 267 Kingsland Road

1 message

Steve Race (Cllr) <steve.race@hackney.gov.uk>
To: "Licensing (Shared Mailbox)" <licensing@hackney.gov.uk>
Cc: "Kam Adams (Cllr)" <kam.adams@hackney.gov.uk>

19 January 2022 at 16:41

Dear Licensing team,

As ward councillors for Hoxton East & Shoreditch we write to object to the granting of the licence application for The Kings Land, [267 Kingsland Road](#), brought by TKL Inc.

This site was previously occupied by a nightclub, Shelter. This venue, along with others that have developed along Kingsland Road, back onto the Whitmore Estate in our ward, a social housing estate run by Metropolitan housing association.

Over several years, as local councillors, Cllr Kam Adams and I have been supporting residents in their struggle against noise pollution and antisocial behaviour that have been the result of the creeping development of the NTE up Kingsland Road. This venue was one of the main venues that aggravated noise and ASB in the area.

Many of the residents whose lives have been made a misery by late-night noise and ASB are key workers, shift workers, and families. They have experienced very loud and continuous shouting, large fights between groups of men (some of which included weapons including guns), car horns blaring and music playing, and public urination and defecation. This activity often continued throughout the night and was most acute at closing time in the early hours of the morning. Residents felt unsafe in their own homes.

This application, for new licences to be granted allowing music until 04.30am and sale of alcohol up to 5am in the morning is clearly unacceptable for a venue that is so close to a large residential area. We object on the basis that these licences will add to the cumulative negative impact on local residents and further that granting the licences will add to crime and disorder; add to public nuisance; add to a decline in public safety; and add to a decline in the public health of residents in the area.

Cllr Adams and I therefore ask that the licensing committee reject this application.

With best wishes - Steve

Steve Race,
Labour Councillor for Hoxton East & Shoreditch
London Borough of Hackney

e: steve.race@hackney.gov.uk t: [@steve_race](https://twitter.com/steve_race)



Disclaimers apply, for full details see: <https://hackney.gov.uk/email-disclaimer>

APPENDIX D

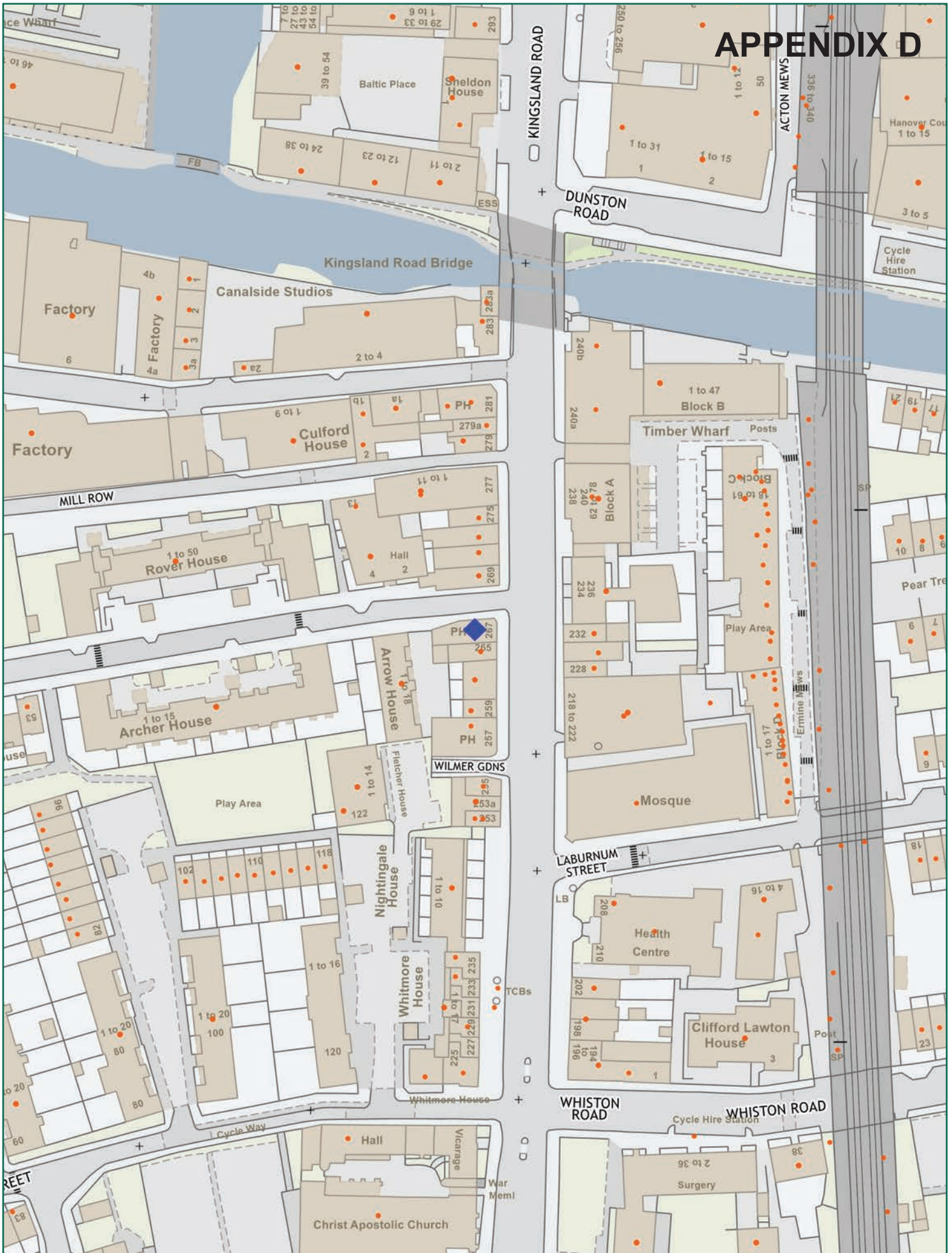

Scale: 1:1250 at A4

The Kings Land, 267 Kingsland Road, E2 8AS



Ref:

Tuesday, February 22, 2022

Produced by: unspecified

email:

please specify copyright statement